

EXTRA BREED

EXTRA BREED

PLANKBREEDTE 24,4 CM

GESCHIKT VOOR
INTENSIEF GEBRUIK

25 JAAR GARANTIE

NATUURLIJKE
UITSTRALING

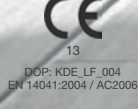
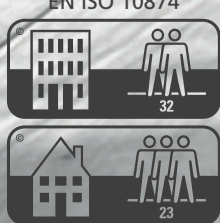

Bodenbelag zur Verwendung in Gebäuden,
Floor Covering for internal use,
NB 0766, Cfl-s1, E1, DS
SWISS KRONO TEX GmbH & Co. KG
Wittstocker Chaussee 1
16909 Heiligengrabe
www.kronotex.com

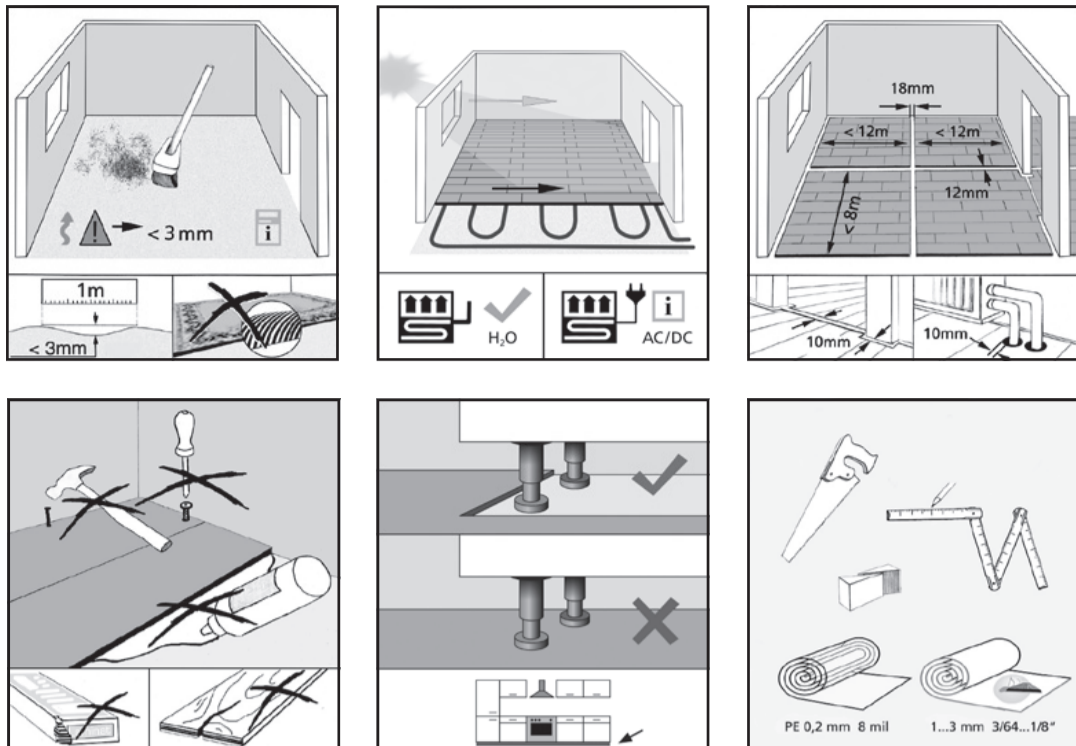

INSTALLATION

1. Prepare the room and lay out the PE 0,2 mm membrane. A 20 cm offset is indicated.
2. Lay the first row of flooring, ensuring a 10 mm gap from the wall.
3. Lay the second row of flooring, ensuring a 10 mm gap from the wall.
4. Lay the third row of flooring, ensuring a 10 mm gap from the wall.
5. Lay the fourth row of flooring, ensuring a 12° angle and a $> 400\text{ mm}$ length.
6. Lay the fifth row of flooring, ensuring a 12° angle and a $> 400\text{ mm}$ length.
7. Lay the sixth row of flooring, ensuring a 12° angle and a $> 400\text{ mm}$ length. The "Clic" sound is indicated.
8. Final room layout and furniture placement.
9. Lay the seventh row of flooring, ensuring a 10 mm gap from the wall.
10. Lay the eighth row of flooring, ensuring a 10 mm gap from the wall.
11. Lay the ninth row of flooring, ensuring a 10 mm gap from the wall.
12. Lay the tenth row of flooring, ensuring a 10 mm gap from the wall.
13. Lay the eleventh row of flooring, ensuring a 10 mm gap from the wall.
14. Lay the twelfth row of flooring, ensuring a 10 mm gap from the wall.

REMOVAL

