

DELTA/ORBITAL SANDER

Intended use

The machine is intended for dry sanding of wood, plastic, plaster and painted surfaces.

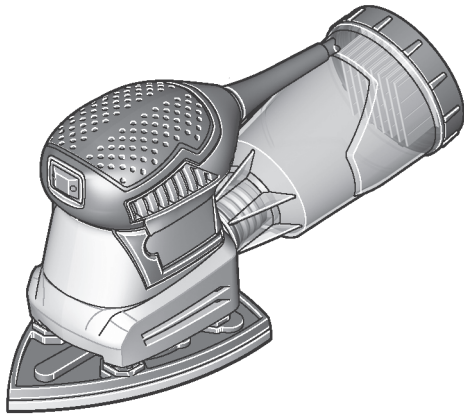

Caution!

Improper handling can injure the user or damage the device. Read the safety instructions first!

SAFETY INSTRUCTIONS



Tool specific safety precautions

- **Wear ear protection.**
- **Use the power tool only for dry sanding.** Water entering the power tool increases the risk of electric shock.
- **Caution, fire hazard! Avoid overheating of the material being sanded and the sander. Always empty the saw dust collecting bag when pausing from work.** Sawdust in dust bag, micro filter, paper dust bag (filter bag or filter of the vacuum cleaner) can ignite under unfavourable conditions, such as by sparks when sanding metals. Increased hazards exists when the saw dust is mixed with residues of lacquer, polyurethane or other chemicals and the saw dust is hot after extensive work.
- **Secure the work piece.** A work piece secured by a clamp or with a bench vice is more stable than held by hand.
- **Keep your workplace clean.** Material mixtures are particularly dangerous. Light metal dust may ignite or explode.
- **Do not use the power tool with a damaged cable. Do not touch the damaged cable and disconnect the plug from the mains if the cable is damaged during operation.** Damaged cables increase the risk of electric shock.

Failure to follow the warnings and regulations may result in electric shock, fire or serious injury.

1. ILLUSTRATED COMPONENTS

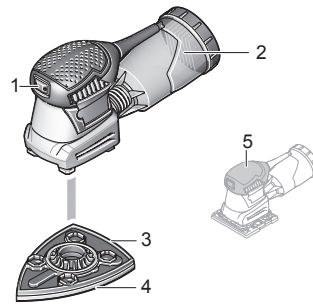

1. On-off switch
2. Dust box complete (Micro filter System)
3. Triangular base plate
4. Sanding plate
5. Handle (insulated)

2. ASSEMBLY

- **Always remove the power plug from the mains.**

Own extraction with dust box (see pictures B - E)

Slide the dust box **2** on the extraction outlet **14**.

The filling level of the dust box **2** The transparent reservoir allows an easy check. Pull and loosely rotate the dust box **2** out to empty it.

Screw the filter element **15** off the dust box **2**. Empty the dust box.

Tap the filter element **15** lightly on a solid surface to loosen the dust. Clean the filter element slats **15** with a soft brush.

Note: To achieve optimal dust extraction, empty the dust box **2** and clean the filter element **15** regularly.

When working on vertical surfaces, hold the power tool so that the dust box **2** points downwards.

External extraction (see figure F)

Insert the vacuum hose **16** on the extraction outlet **14**. Connect the vacuum hose **14** to a vacuum cleaner. The vacuum cleaner must be suitable for the material to be processed.

Replacing Sanding Sheet

Remove dirt and dust from the sanding plate **6** with a brush for example before applying a new sanding sheet.

To achieve optimum dust extraction, make sure that the perforations in the sanding sheet match the holes in the sanding plate.

Sanding Sheets with Velcro backing (See Figure A)

The sanding plate **6** is provided with Velcro backing for quick and easy application of a new sanding sheet.

Tap the sanding plate **6** remove and dust etc. before applying a new sanding sheet **9** ensuring optimum adhesion.

Place the sanding sheet **9** on one side of the sanding plate **6** then place the whole sanding sheet on the sanding plate and firmly press it.

To remove it the sanding sheet **9** grab it on the tip and pull it loose from the sanding plate **6**.

3. OPERATING

Operating

- **Observe the mains voltage! The voltage must match the data on the power tool type plate. 230V electric power tools can also be used with 220V.**

Switching on and off

To turn on the power tool, push the power switch **1** to the right in position "I".

To turn off the power tool, push the power switch **1** to the left in position "0".

4. TIPS FOR OPERATING

- **Wait until the power tool has come to a standstill before you put it down.**

The abrasion abilities are mainly determined by the choice of sanding sheets.

Only undamaged sanding sheets ensure optimal sanding and avoid overloading the power tool.

Ensure you apply an even pressure to extend the life of the sanding sheets .
An excessive increase in pressure does not lead to a greater sanding, but to an increased wear of the power tool and the sanding sheet.

Do not use a sanding sheet that has been used to sand metal for other material.

5. MAINTENANCE AND CLEANING

- **Before working on the power tool always remove the plug from the mains.**
- **Always keep the power tool and the ventilation openings clean in order to work efficiently and safely.**

**Contact the rental company should you encounter problems the machine!
The machine must be returned clean and undamaged.**

