

TILE SAW TABLE LARGE

The cutter with diamond saw disc is suitable for cutting ceramics, both flat and at 45 ° (jolly). The cutting depth and the cutting angle can be adjusted.

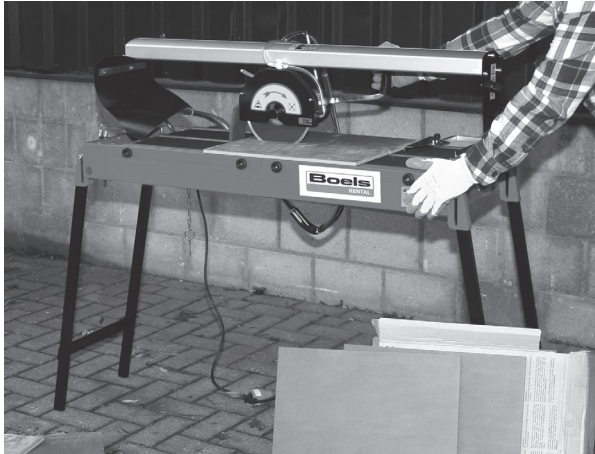

SAFETY INSTRUCTIONS



Take note of the following points:

- let the motor run slowly and ensure that the disc rotates freely.
- Make sure that the work piece is firmly placed against the lateral stop.
- Check before each cut that the knobs for setting the cutting angle have been tightened.

2. TRANSPORT

The tile saw machine can be easily transported by the handles on the side. Before moving the machine, check whether:

- The motor carriage is secured with the two cutting adjustment knobs on the rail along which the carriage moves;
- The motor has been completely lowered and secured with the return lever;
- The machine is angled at 45 ° (jolly) and the knobs for adjusting the cutting angle are properly tightened;
- The shaft carrying the lead from its housing has been pushed out;
- The legs are locked and the locking pin for the brackets has been fitted (photo 4).

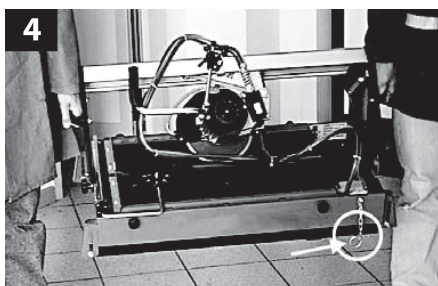

3. PRE-OPERATING CHECKS

THE TILE SAW IS INTENDED FOR USE WITH WATER.

Before starting cutting work, check that there is enough water in the reservoir (photo 5).

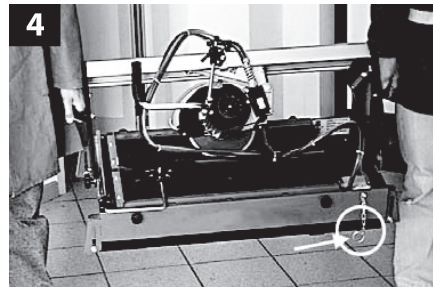

ADJUSTING FLOW COOLING WATER.

With the adjustable valve placed on the disc protection cover, you can adjust the water flow for the material to be cut. This is made possible by an innovative cooling system, which keeps the disc constantly wet.

4. CUTTING AT RIGHT ANGLE

The versatile tile saw machine can perform different types of cuts.

Set the disc to 0 ° with the cut-angle adjustment knobs (photo 7). Place the work piece on the work surface and check that it is securely placed against the tile support. If necessary, use the angular stop.

THE SCALE ON THE WORK AREA IS ONLY MEANT FOR LINEAR CUTS.

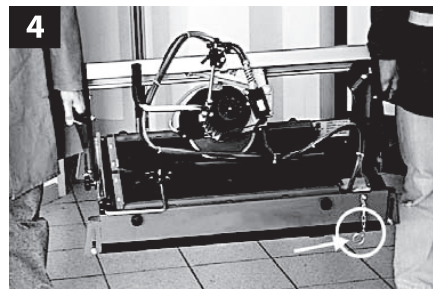

Place the tile for a diagonal cut against the angular stop hook (photo 7) and start the cut.

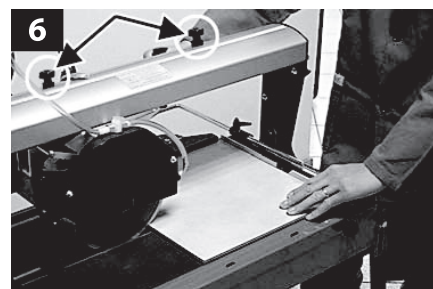

5. CUTTING AT A 45° ANGLE

Set the disc to 45 ° with the cut-angle adjustment buttons (photo 7).

lock the motor car with the return lever to the maximum cut depth position. Figure 8 shows how the machine should be used.

With the tile saw machine you can also:

- Adjust the length of the cut using the cutter knobs (photo 6).
- Set the depth of the cut using the return lever (photo 8).
- Adjust the straight cut dimension using the angular stop for the tile and the scale on the work surface (photo 6).
- Adjust the centre of the cut using the indicator shown above and the scale on the scroll bar.

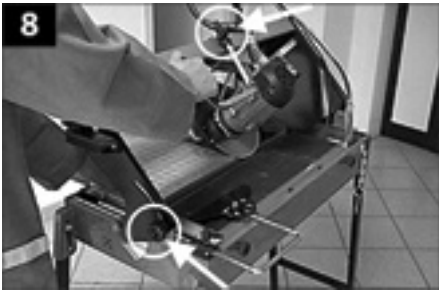

For any special operations, an arbitrary cutting angle between 0 ° and 45 ° (indicated on the side of the machine) can be set (photo 9).



6. MAINTENANCE

CLEANING

The tile saw machine can be easily cleaned by loosening the side knobs and removing the work surface. Remove processing residues via the side cap from the machine (photo 10).

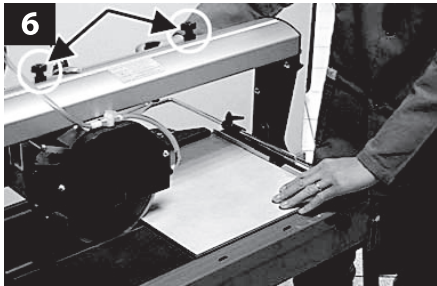

Contact your rental company should you encounter problems with the machine!

The product must be returned clean and undamaged.