

ORBITAL SANDER

Use according to design

The electric tool is intended for dry sanding of wood, plastic, metal, plaster and painted surfaces. Electric tools with electronic control are also suitable for polishing.

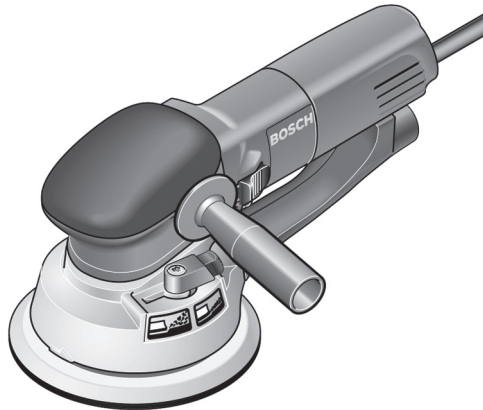

SAFETY INSTRUCTIONS



- Use the power tool only for dry sanding.
- Make sure no person is endangered by flying sparks. Remove combustible materials from the vicinity.
- Caution, fire hazard! Prevent overheating of the material to be sanded and the sander. Always empty the saw dust collecting bag when pausing from work.
- Hold the power tool firmly with both hands during work and ensure that you standing are firm.
- Secure the work piece. A work piece secured by a clamp or with a bench vice is held better than held by hand.

1. ILLUSTRATED COMPONENTS

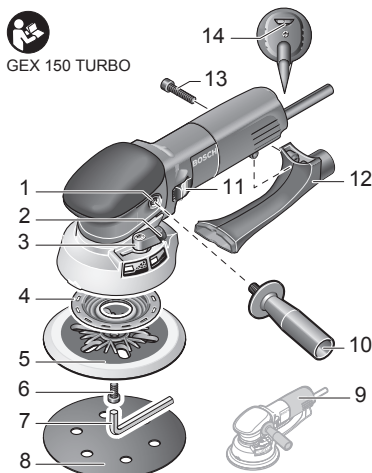

1. Threaded hole
2. Unlocking button
3. Function switch
4. Seal Collar
5. Sanding disc
6. Screw for sanding disc
7. Allen wrench
8. Sanding disc*
9. Handle (insulated grip)
10. Extra handle (insulated grip) *
11. On/Off switch
12. Outlet
13. Bolt for outlet pipe
14. Adjustable wheel for pre-adjustable sanding functions

* Not all accessories pictured and described are delivered as standard.

2. INSTALLATION

- Before starting work with the power tool always remove the plug from the mains.

Exchanging sanding disc

If you need to exchange sanding disc **8**, tilt it sideways and pull loose from the sanding disc **5**. Before placing a new sanding disc, remove dirt and dust from the sanding plate **5**, use a brush. The surface of the sanding plate **5** consists of Velcro backing, for quick and easy attachment of sanding discs with Velcro adhesion. Press sanding disc **8** firmly to attach to the underside of sanding plate **5**. To achieve optimal dust extraction, make sure that the perforations in the sanding disc match the boreholes in the sanding plate.

3. OPERATING

Commencing

Operating Switch on/off

To turn on the power tool, push the power switch **11** forward. Press the on / off switch **11** to lock it, press the power switch **11** down until it snaps into place. If you want to switch off the power tool then release the on/off switch **11**. If it is locked, press the power button **11** briefly back down and then release it. To save energy, only switch the power tool on when you are using it.

Pre-set rate of sanding movements

With the adjusting wheel **14** you can set the required rate of sanding movements, even when the machine is running.

- 1 - 2 low rate of sanding movements
- 3 - 4 average rate of sanding movements
- 5 - 6 high rate of sanding movements

The required number of sanding movements depends on the material and working conditions and can be determined by simply trying it out. The constant-electronic keeps the number of sanding movements with the machine loaded and unloaded virtually constant and ensures even working conditions. After prolonged work with a low rate of sanding movements, allow the electric tool to cool for approx. 30 seconds by running it unloaded with the maximum number of sanding movements.

The Choice of load capacity

There are two different load capacities available. To change the load capacity, press the unlock button **2** and turn the function switch **3** to the symbol of the desired function until it clicks audibly.

- Do not change the function whilst sanding! There is an injury hazard.

Function 1 (forced drive)

This high sanding function is recommended for the processing of very rough, non-fragile surfaces and for polishing. As a result of the forced drive of the sanding plate, a constant eccentric and rotational motion is achieved.

Function 2 (free run)

This feature is recommended for the treatment of fragile surfaces and fine polishing. Due to free run of the abrasive plate, application pressure depended rotational motion is achieved with a constant eccentric motion. By varying the application pressure you can regulate the amount of material removal.

4. MAINTENANCE AND SERVICE

Maintenance and cleaning

- Before starting work with the power tool always remove the plug from the mains.
- Always keep the power tool and the ventilation openings clean to work efficiently and safe.

Contact your rental company should you encounter problems with the machine!

The product must be returned clean and undamaged.